

NOTICE OF DETOUR & **CONSTRUCTION ACTIVITY NOTICE**

To Robbinsville Township Residents

Please be advised that, as part of the Turnpike Widening Program, the West Manor Way Bridge over the New Jersey Turnpike will be removed and reconstructed. Starting on or about October 28, 2011, West Manor Way will be closed to traffic between Patriot Drive and Applegate Drive for approximately 15 months. A detour will be in place to guide traffic around the closed portion of West Manor Way.

The NJ Turnpike Authority apologizes for any inconvenience. If you have any questions or require additional information, please visit the Widening website at www.njturnpikewidening.com or call the Widening Program's question line at 1-877-NJT-WIDE (1-877-658-9433).

PROJECT: NJ Turnpike Interchange 6 To 9 Widening Program
Contract # T869.120.402
Interchange 7A, Structures & Roadways NJT Mileposts 59.7 to 62.0
Township of Robbinsville, Mercer County, NJ

WORK LOCATION: West Manor Way bridge over the NJ Turnpike

WORK DATES: Starting on or about October 28, 2011

WORK DURATION: Approximately 15 months

WORK HOURS: 7:00 AM TO 5:00 PM Monday through Saturday

**CONSTRUCTION
ACTIVITY:** West Manor Way Bridge demolition & reconstruction

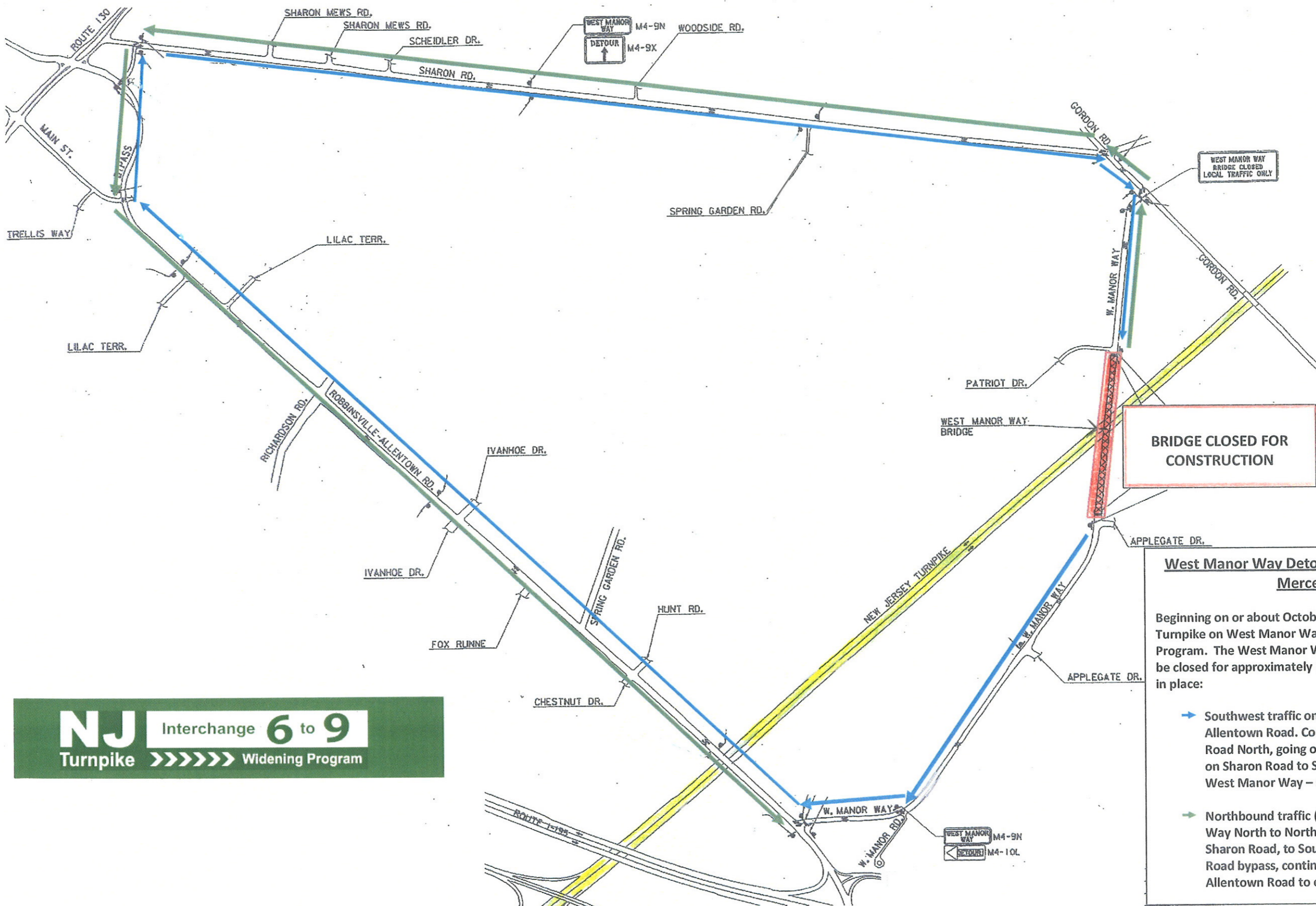

NJ Interchange **6 to 9**
 Turnpike >>>>> Widening Program

BRIDGE CLOSED FOR CONSTRUCTION

West Manor Way Detour, Township of Robbinsville, Mercer County, NJ

Beginning on or about October 28, 2011, the bridge over the NJ Turnpike on West Manor Way will be closed due to the Widening Program. The West Manor Way Bridge over the NJ Turnpike will be closed for approximately 15 months. The following Detour is in place:

- ➔ Southwest traffic on West Manor Way to Robbinsville-Allentown Road. Continue on Robbinsville-Allentown Road North, going on the bypass to Sharon Road. East on Sharon Road to South on Gordon Road, South on West Manor Way – stop at Patriot Drive.
- ➔ Northbound traffic (Patriot Drive) follow West Manor Way North to North on Gordon Drive. Go West on Sharon Road, to South on the Robbinsville-Allentown Road bypass, continuing Southeast on Robbinsville-Allentown Road to end Detour.